

| REVISIONS | | | | | |
|-----------|-----|---------------------------------|-----------|-------|------|
| REV | ECO | DESCRIPTION | DATE | BY | APPR |
| A3 | - | RELEASE NEW DWG FORMAT | 03JAN14 | JARRY | |
| A4 | - | REVISED IP RATINGS TO IP68/IP69 | 17DEC2025 | JHEAD | DH |

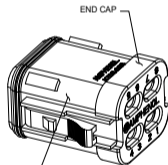
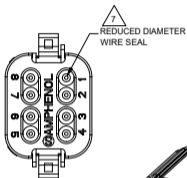
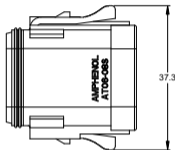
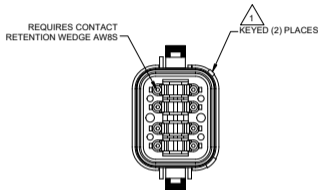
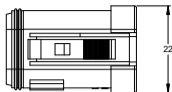

NOTES: UNLESS OTHERWISE SPECIFIED

1 SEE SHEET 2 FOR KEY ARRANGEMENTS AND COLORS.

2. MATERIAL:
HOUSING: THERMOPLASTIC
SEAL: SILICONE RUBBER

3. MODIFICATIONS: END CAP:
REDUCED DIAMETER WIRE SEAL

4. SPECIFICATIONS:

- 4.1 CURRENT RATING: 13 AMPS
- 4.2 OPERATING TEMPERATURE: -55°C TO +125°C
- 4.3 DIELECTRIC WITHSTANDING VOLTAGE: LESS THAN 2 MILLIAMPS CURRENT LEAKAGE @ 1500 VOLTS AC.
- 4.4 INSULATION RESISTANCE: 1000 MEGOHMS MIN @ 25°C.
- 4.5 MOISTURE RESISTANCE: IP68 (1M OF WATER FOR A PERIOD OF 24 HOURS, MATED CONDITION) IP69K (MATED CONDITION)
- 4.6 MATING CYCLE DURABILITY: 100 CYCLES
- 4.7 RoHS COMPLIANT

5. MATING PART: AT04-08PX* RECEPTACLE
(X = A,B,C,D KEYS; * = MODIFICATIONS AND COLORS)

6. ALL DIMENSIONS ARE FOR REFERENCE USE ONLY.

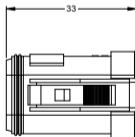

7 CONTACT SIZE AND REAR SEAL WIRE RANGE:

| CONTACT SIZE | MIN. INSUL O.D. | MAX. INSUL O.D. | TYPICAL WIRE RANGE |
|--------------|----------------------|----------------------|--------------------|
| 16 | 1.35 mm (.053 in) | 3.05 mm (.120 in) | 14 - 20 AWG |

1 REFER TO SHEET 2 FOR AVAILABLE CONNECTOR COLORS

| SEE PART NUMBER CHART | | PART NUMBER | | DESCRIPTION | | ITEM |
|--------------------------------------|----------------|--|--|-----------------|--|--------|
| QUANTITY | MATERIALS LIST | | | | | |
| UNLESS OTHERWISE SPECIFIED: | | SIGNATURES | | DATE | | |
| 1) All dimensions are in millimeters | | DESIGN | | 03JAN14 | | |
| 2) Tolerances are as follows: | | CHECKED | | | | |
| 3) PL DEC ±0.15 Fractions ± 1/64 | | ENGINEER | | | | |
| 4) PL DEC ±0.15 Angles ±0.1 | | APPROVAL | | | | |
| 5) Note reference = 1 | | CUSTOMER | | | | |
| MATERIAL SPECIFICATIONS | | PROCESS SPECIFICATIONS | | FINISH | | FINISH |
| | | FURNISHING IS SUPPLIED FOR INFORMATION ONLY. DESIGN FEATURES, SPECIFICATIONS AND PERFORMANCE DATA SHOWN HEREON ARE THE PROPERTY OF THE SUPPLIER. COOPERATION AND RESULTS OF REPRODUCTION ARE IMPLIED. ALL DIMENSIONS ARE SUBJECT TO NORMAL MANUFACTURING VARIATIONS. | | SCALE | | SCALE |
| | | | | NONE | | |
| | | | | B C- | | |
| | | | | AT06-08SX-MMXXX | | A4 |
| | | | | SHEET 1 | | OF 2 |

| REVISIONS | | | | |
|-----------|-----|-------------|------|---------|
| REV | ECO | DESCRIPTION | DATE | BY APPR |

P/N AT06-08SA-MM01
KEY-A CONFIGURATION
STANDARD COLOR: GREY

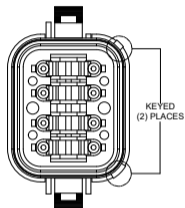

P/N AT06-08SB-MM01
KEY-B CONFIGURATION
STANDARD COLOR: BLACK

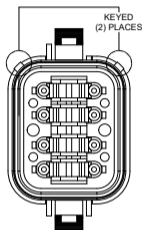

P/N AT06-08SC-MM01
KEY-C CONFIGURATION
STANDARD COLOR: GREEN

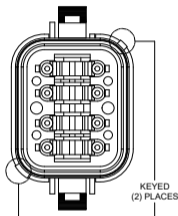

P/N AT06-08SD-MM01
KEY-D CONFIGURATION
STANDARD COLOR: BROWN

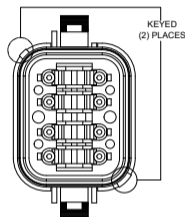

| KEY-A CONFIGURATION | |
|---------------------|-------------------|
| COLOR | PART NUMBER |
| * GREY | AT06-08SA-MM01 |
| BLACK | AT06-08SA-MM01BK |
| GREEN | AT06-08SA-MM01GRN |
| BROWN | AT06-08SA-MM01BRN |

| KEY-B CONFIGURATION | |
|---------------------|-------------------|
| COLOR | PART NUMBER |
| GREY | AT06-08SB-MM01GRY |
| * BLACK | AT06-08SB-MM01 |
| GREEN | AT06-08SB-MM01GRN |
| BROWN | AT06-08SB-MM01BRN |

| KEY-C CONFIGURATION | |
|---------------------|-------------------|
| COLOR | PART NUMBER |
| GREY | AT06-08SC-MM01GRY |
| BLACK | AT06-08SC-MM01BK |
| * GREEN | AT06-08SC-MM01 |
| BROWN | AT06-08SC-MM01BRN |

| KEY-D CONFIGURATION | |
|---------------------|-------------------|
| COLOR | PART NUMBER |
| GREY | AT06-08SD-MM01GRY |
| BLACK | AT06-08SD-MM01BK |
| GREEN | AT06-08SD-MM01GRN |
| * BROWN | AT06-08SD-MM01 |

NOTE:

AN ASTERISKS (*) PLACED BEFORE THE COLOR DENOTES THE STANDARD MOLDED COLOR OF THE CONNECTORS SHOWN ABOVE.

OTHER COLORS SHOWN ARE AVAILABLE VIA SPECIAL ORDER.

| SEE PART NUMBER | | DESCRIPTION | | ITEM | |
|--|--|---|--|---|--|
| CHART | | PART NUMBER | | | |
| QUANTITY | | MATERIALS LIST | | | |
| <small>1) AS SHOWN UNLESS OTHERWISE SPECIFIED</small> <small>2) Dimensions are in millimeters</small> <small>3) Tolerances are as follows:</small> <small>1 P/L DEC 40.30 ± .000 (maximum)</small> <small>2 P/L DEC 40.18 ± .000 (maximum)</small> <small>3 P/L DEC 40.08 ± .000 (maximum)</small> <small>4) Angles ± 1/2°</small> <small>5) Hole reference -</small> | | <small>REVISIONS</small> <small>REV</small> <small>DATE</small> 0000 JARY 03JUN14 <small>CHECKED</small> <small>DESIGNED</small> <small>APPROVAL</small> <small>DATE</small> <small>BY</small> <small>REVISIONS</small> | | Amphenol Sine Systems - www.amphenol-sine.com 44724 Morley Drive Clinton Township, MI 48036 | |
| <small>MATERIAL SPECIFICATIONS</small> <small>1) CLOUTIER</small> <small>2) OTHER</small> | | <small>THIS DRAWING IS SUPPLIED FOR INFORMATION ONLY. DESIGN FEATURES, SPECIFICATIONS AND PERFORMANCE DATA INDICATED HEREON ARE THE PROPERTY OF THE AMPHENOL CORPORATION. NO RIGHTS OF REPRODUCTION ARE GRANTED. ALL DIMENSIONS ARE SUBJECT TO NORMAL MANUFACTURING VARIATIONS.</small> | | PLUG, 8 SOCKET, AT SERIES, END CAP, KEYED, REDUCED DIAMETER WIRE SEAL | |
| <small>PROCESS SPECIFICATIONS</small> <small>1) NONE</small> <small>2) NONE</small> <small>3) NONE</small> | | <small>SCALE</small> NONE | | <small>REV</small> <small>DATE</small> B C- AT06-08SX-MMXXX A4 | |
| <small>SHEET APPR</small> | | <small>SHEET</small> 2 <small>OF</small> 2 | | <small>DATE</small> | |

TITLE: PLUG, 8 SOCKET, AT SERIES, END CAP, KEYED, REDUCED DIAMETER WIRE SEAL
 DRAWING: AT06-08SX-MMXXX
 REV: A4
 SHEET: 2 OF 2